



**Marine Warehouse**  
2330 NW 102 Avenue, Suite 1  
Doral, FL 33172  
USA  
Tel: (305) 635-0776  
sales@marinewarehouse.net

---

## **Isotherm DRAWER 160 INOX LIGHT - DRAWER refrigerators / freezers**

The Drawer 160 LIGHT is an innovative evolution of the original Drawer 160 FROST-FREE. With AC/DC functionality, the Drawer 160 Light uses evaporator technology to deliver reliable cooling at a more economical price.

The Drawer 160 Light AC/DC models are available in three versions: (1) Fridge/Freezer, (2) Fridge only, and (3) Freezer only.

The upper drawer of the Drawer 160 Light Fridge / Freezer model consists of a 3.2 cubic foot refrigeration compartment while the lower drawer contains a 2.3 cu. ft. freezer. Total storage volume is 5.5 cubic feet.

The Isotherm Drawer 160 models are unique in this class of AC/DC based refrigeration in that the refrigerator section on the fridge/freezer is in the top drawer which also makes it more convenient for everyday use.

Drawer design is also a critical factor that make Isotherm unique. The drawer slides are Blum ball-bearing under-support which provide greater support for weight and drawer stability vs. the common side rails used by competitors. The spring operated soft close mechanism acts independently of load and closes the drawer safely and automatically. The hallmark of this design gives it perfect vertical and lateral stability as well as securing the drawer shut without additional actions. The resilient maintenance-free tracks ensure optimal smoothness with precision guided ball bearings. A superior fit with simple slide-on assembly, the drawer can be removed and replaced by simply placing it on the runners and pushing it back into place. The catch automatically locks the drawer securely to the rail and the positive latching handle keeps the drawer securely shut in the even the roughest conditions.



The drawer face allows for easy replacement and adjustment of pitch, yaw, and angle to keep the drawer face flush with the body over years of usage.

Like all Isotherm products, the Drawer models are backed by the exclusive Isotherm 5-year limited warranty on all compressors and two years on all parts.



### **Your Advantages:**

- Volume: 155 liters
- Easy user-friendly access
- Robust drawer mechanism
- Stainless steel front door
- Double-drawer setup
- Mechanical thermostat
- Internal Light (besides on double freezer version)

---

Marine Warehouse

Miami - Trinidad - Panama - Grenada - Tahiti - Curacao - Bonaire - Aruba - St Maarten - Colombia - Langkawi - Nuku-Hiva - Raiatea



**Marine Warehouse**  
2330 NW 102 Avenue, Suite 1  
Doral, FL 33172  
USA  
Tel: (305) 635-0776  
sales@marinewarehouse.net



**Technical Details:**

- Type: DR160 LIGHT INOX
- Volume (cu.ft): 5.5
- Dimensions: 34h x 24.6w x 23.4d (for all models)
- Weight: 99 Lbs.

**Flush Mount Models (Dimensions see page 3 below)**

**3160BA7C00017** - Double Drawer 160 LIGHT REFRIGERATOR ONLY - 5.5 Cu. Ft. - Stainless Steel - 4 sided flush mount flange - AC/DC

**3160BB3C00017** - Double Drawer 160 LIGHT REFRIGERATOR / FREEZER - 5.5 Cu. Ft. - Stainless Steel - 4 sided flush mount flange - AC/DC

**3160BC3C00017** - Double Drawer 160 LIGHT FREEZER ONLY - 5.5 Cu. Ft. - Stainless Steel - 4 sided flush mount flange - AC/DC

**3160BM6C00017** Double Drawer 160 Light Fridge / Freezer / Ice-Maker - 5.5 Cu. Ft. - Stainless Steel 4-Sided Flush Flange - 115V AC

**3160BN6C00017** Double Drawer 160 Light Freezer Only with Ice Maker - 5.65 Cu. Ft. - Stainless Steel 4-Sided Flush Flange - 115V AC

**Proud Mount Models (Dimensions see page 4 below)**

**3160BA7C00025** - Double Drawer 160 LIGHT REFRIGERATOR ONLY 5.5Cu. Ft. - Stainless Steel - 4 sided proud mounted flange - AC/DC

**3160BB3C00025** - Double Drawer 160 LIGHT REFRIGERATOR / FREEZER 5.5 Cu. Ft. - Stainless Steel - 4 sided proud mounted flange - AC/DC

**3160BC3C00025** - Double Drawer 160 LIGHT FREEZER ONLY 5.5 Cu. Ft - Stainless Steel - 4 sided proud mounted flange - AC/DC

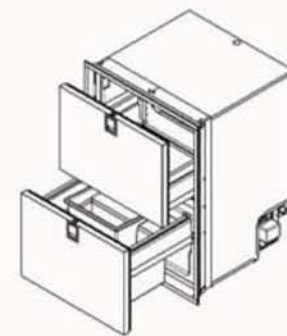
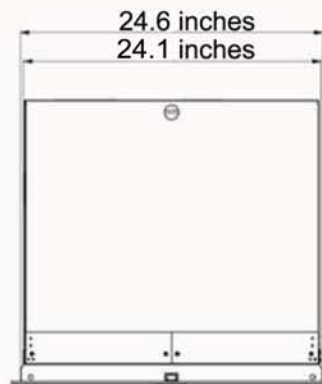
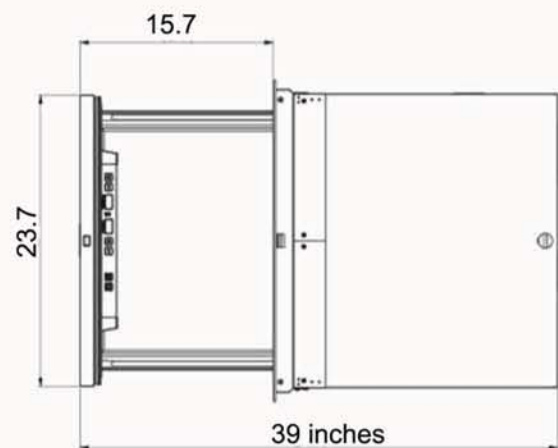
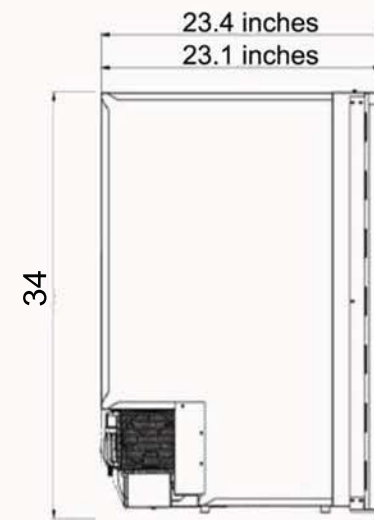
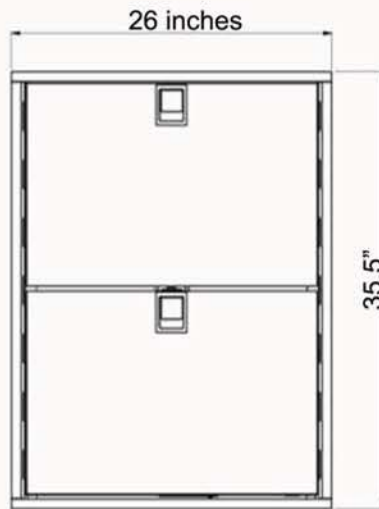
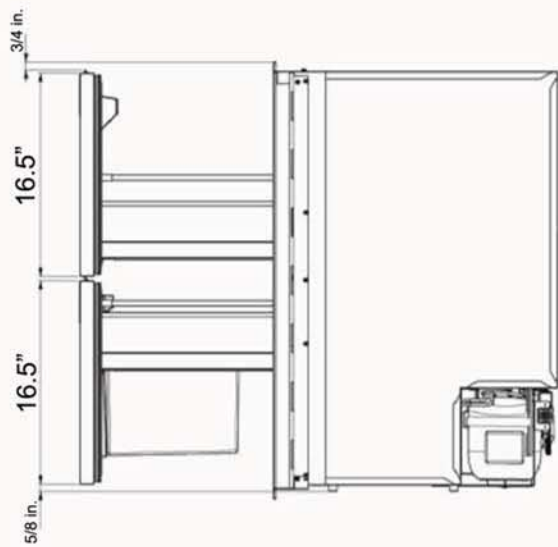

Tutti i materiali e componenti sono devoluti come nuovi, originali.  
 Questo prodotto è conforme ai requisiti di legge.  
 IFR (FRIGERIFROSTADORI) (FRIG.)  
 Marchio Registrato del Tribunale di Genova del 12 gennaio 1988

DENOMINAZIONE					
Prodotto	Denominazione	Quantità	Stato/Anno	Paese	Codice
ISO 3748 - 81	FRIGERIFROSTADORI (FRIG.)	1	2024/2025	ITALIA	2336,09
					2,5
					2,5
Inverter Ariston Energy Group Via S. Margherita, 100 - 11100 - 11100 - 11100 - 11100 Tel. 0172/244444 - Fax 0172/244444 Email: info@ariston.com - www.ariston.com CODICE: CPO14042630214049					

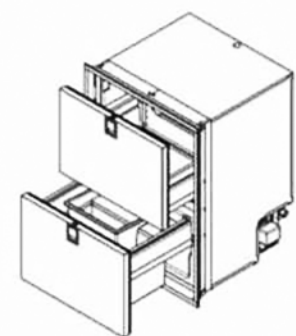
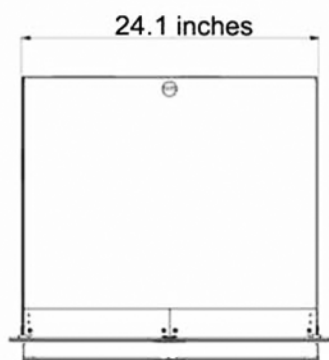
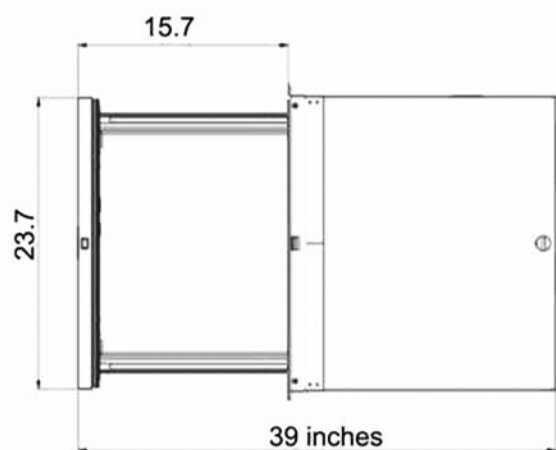
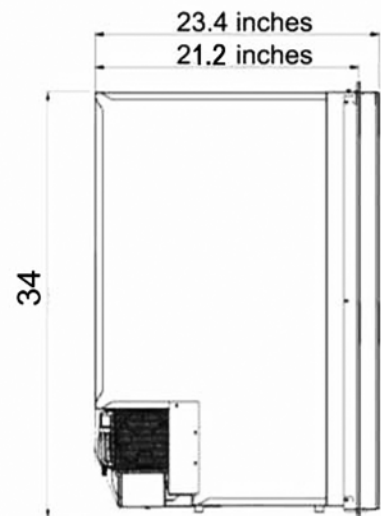
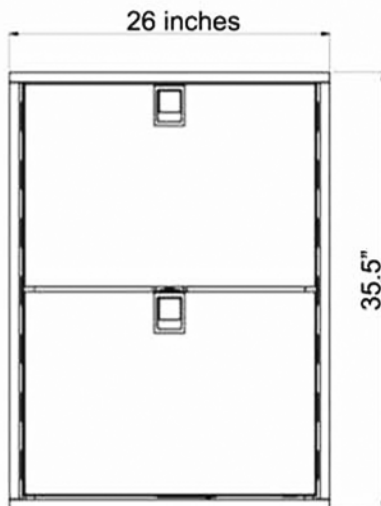
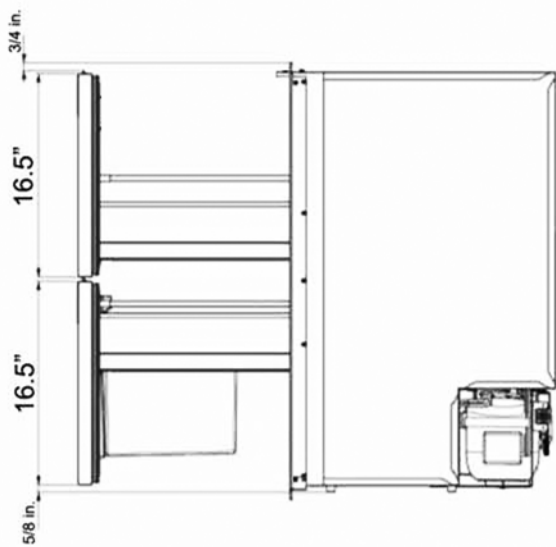

Tutti i marchi e i componenti sono marchi registrati.  
 CREDIT: CREDIT EQUIPMENT, SPINA POLIMERI, PNEU D.  
 SPINA POLIMERI POLIMERI PNEU D.  
 Distribuzione esclusiva per l'Italia del Gruppo dei 11 partner PNEU

Isotherm Drawer 160 Proud Mount					
Pos.	DESCRIZIONE	Q.	Misure	Stato/Anno	Prezzo
1	DESCRIZIONE	1	1600x600x580	2023	1.100,00
2	DESCRIZIONE	1	1600x600x580	2023	1.100,00
3	DESCRIZIONE	1	1600x600x580	2023	1.100,00
4	DESCRIZIONE	1	1600x600x580	2023	1.100,00
5	DESCRIZIONE	1	1600x600x580	2023	1.100,00
6	DESCRIZIONE	1	1600x600x580	2023	1.100,00
7	DESCRIZIONE	1	1600x600x580	2023	1.100,00
8	DESCRIZIONE	1	1600x600x580	2023	1.100,00
9	DESCRIZIONE	1	1600x600x580	2023	1.100,00
10	DESCRIZIONE	1	1600x600x580	2023	1.100,00
11	DESCRIZIONE	1	1600x600x580	2023	1.100,00
12	DESCRIZIONE	1	1600x600x580	2023	1.100,00
13	DESCRIZIONE	1	1600x600x580	2023	1.100,00
14	DESCRIZIONE	1	1600x600x580	2023	1.100,00
15	DESCRIZIONE	1	1600x600x580	2023	1.100,00
16	DESCRIZIONE	1	1600x600x580	2023	1.100,00
17	DESCRIZIONE	1	1600x600x580	2023	1.100,00
18	DESCRIZIONE	1	1600x600x580	2023	1.100,00
19	DESCRIZIONE	1	1600x600x580	2023	1.100,00
20	DESCRIZIONE	1	1600x600x580	2023	1.100,00
21	DESCRIZIONE	1	1600x600x580	2023	1.100,00
22	DESCRIZIONE	1	1600x600x580	2023	1.100,00
23	DESCRIZIONE	1	1600x600x580	2023	1.100,00
24	DESCRIZIONE	1	1600x600x580	2023	1.100,00
25	DESCRIZIONE	1	1600x600x580	2023	1.100,00
26	DESCRIZIONE	1	1600x600x580	2023	1.100,00
27	DESCRIZIONE	1	1600x600x580	2023	1.100,00
28	DESCRIZIONE	1	1600x600x580	2023	1.100,00
29	DESCRIZIONE	1	1600x600x580	2023	1.100,00
30	DESCRIZIONE	1	1600x600x580	2023	1.100,00
31	DESCRIZIONE	1	1600x600x580	2023	1.100,00
32	DESCRIZIONE	1	1600x600x580	2023	1.100,00
33	DESCRIZIONE	1	1600x600x580	2023	1.100,00
34	DESCRIZIONE	1	1600x600x580	2023	1.100,00
35	DESCRIZIONE	1	1600x600x580	2023	1.100,00
36	DESCRIZIONE	1	1600x600x580	2023	1.100,00
37	DESCRIZIONE	1	1600x600x580	2023	1.100,00
38	DESCRIZIONE	1	1600x600x580	2023	1.100,00
39	DESCRIZIONE	1	1600x600x580	2023	1.100,00
40	DESCRIZIONE	1	1600x600x580	2023	1.100,00
41	DESCRIZIONE	1	1600x600x580	2023	1.100,00
42	DESCRIZIONE	1	1600x600x580	2023	1.100,00
43	DESCRIZIONE	1	1600x600x580	2023	1.100,00
44	DESCRIZIONE	1	1600x600x580	2023	1.100,00
45	DESCRIZIONE	1	1600x600x580	2023	1.100,00
46	DESCRIZIONE	1	1600x600x580	2023	1.100,00
47	DESCRIZIONE	1	1600x600x580	2023	1.100,00
48	DESCRIZIONE	1	1600x600x580	2023	1.100,00
49	DESCRIZIONE	1	1600x600x580	2023	1.100,00
50	DESCRIZIONE	1	1600x600x580	2023	1.100,00

Incol  
 Webasto

CODICE: CPO14K48503LCH48